

Threaded Nozzles – Full Cone Series HGSW

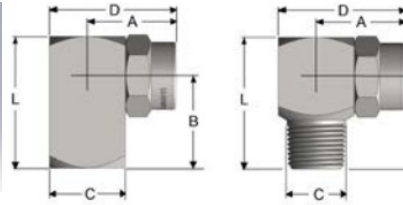
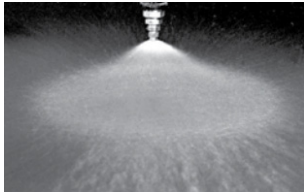

Thread (BSPT)	Dim. A (mm)	Dim. B (mm)	Dim. C (mm)	Dim. D (mm)	Dim. L (mm)
1/8HGSW	18	18	16 SQ	26	25
1/4HGSW	23	25	18 SQ	33	35
3/8HGSW	26	27	21 SQ	38	39
1/2HGSW	30	35	26 SQ	43	48
1/8FHGSW	17	18	16 SQ	23	25
1/4FHGSW	23	25	18 SQ	33	35
3/8FHGSW	26	27	21 SQ	38	39
1/2FHGSW	30	35	26 SQ	43	48

SPRAY CHARACTERISTICS:

A wide angle full cone spray pattern, with uniform distribution throughout the cone.

CONSTRUCTION:

The nozzle contains a patented insert with larger flow passages than older styles, and is less susceptible to clogging. Standard materials are brass, 303 stainless steel, and 316 stainless steel

TYPICAL APPLICATIONS:

- Chemical Processing
- Cooling Sprays
- Foam Breaking
- Continuous Casting

"HGSW" two piece body		Thread BSPT	MAX. FREE PASSAGE (mm)	CAPACITY (L/min) AT VARIOUS PRESSURES (bar)												Spray Angle @		
Female	Male			0.2 bar	0.5 bar	0.7 bar	1 bar	1.5 bar	2 bar	3 bar	4 bar	5 bar	6 bar	8 bar	0.5 bar	1.5 bar	5 bar	
	1/8HGS2.8W	1/8"	1.3	--	0.9	1.07	1.28	1.56	1.8	2.21	2.55	2.85	3.13	3.6	110°	105°	96°	
	1/8HGS4.3W	1/8"	1.3	--	1.39	1.64	1.96	2.4	2.77	3.4	3.9	4.4	4.8	5.5	117°	108°	100°	
	1/8HGS5.6W	1/8"	1.63	--	1.8	2.14	2.55	3.13	3.6	4.4	5.1	5.7	6.3	7.2	117°	110°	100°	
	1/8HGS8W	1/8"	2.06	2	2.58	3.05	3.6	4.5	5.2	6.3	7.3	8.2	8.9	10.3	118°	110°	103°	
	1/4HGS5.6W	1/4"	1.63	1.4	1.8	2.14	2.55	3.13	3.6	4.4	5.1	5.7	6.3	7.2	120°	108°	102°	
	1/4HGS10W	1/4"	2.31	2.5	3.2	3.8	4.6	5.6	6.4	7.9	9.1	10.2	11.2	12.9	118°	108°	102°	
	1/4HGS12W	1/4"	2.31	3	3.9	4.6	5.5	6.7	7.7	9.5	10.9	12.2	13.4	15.5	120°	112°	102°	
	1/4HGS14W	1/4"	2.31	3.5	4.5	5.3	6.4	7.8	9	11.1	12.8	14.3	15.6	18	118°	114°	104°	
	3/8HGS17W	3/8"	2.59	4.2	5.5	6.5	7.7	9.5	11	13.4	15.5	17.3	19	21.9	118°	117°	102°	
	3/8HGS20W	3/8"	2.59	5	6.4	7.6	9.1	11.2	12.9	15.8	18.2	20.4	22.3	25.8	120°	120°	106°	
	3/8HGS24W	3/8"	2.59	6	7.7	9.2	10.9	13.4	15.5	18.9	21.9	24.5	26.8	30.9	122°	118°	106°	
	3/8HGS27W	3/8"	2.59	6.7	8.7	10.3	12.3	15.1	17.4	21.3	24.6	27.5	30.1	35	122°	120°	107°	
	1/2HGS30W	1/2"	3.66	7.5	9.7	11.4	13.7	16.7	19.3	23.7	27.3	30.6	33	39	120°	118°	110°	
	1/2HGS35W	1/2"	3.66	8.7	11.3	13.3	16	19.5	22.6	27.6	32	36	39	45	122°	118°	108°	
	1/2HGS40W	1/2"	4.11	10	12.9	15.3	18.2	22.3	25.8	32	36	41	45	52	122°	119°	104°	
	1/2HGS45W	1/2"	4.11	11.2	14.5	17.2	20.5	25.1	29	36	41	46	50	58	141°	118°	108°	
3/4FHGS50W	3/4HGS50W	3/4"	4.95	12.5	16.1	19.1	22.8	27.9	32	39	46	51	56	64.5	120°	120°	110°	
3/4FHGS71W	3/4HGS71W	3/4"	4.95	17.7	22.9	27.1	32	40	46	56	65	72	79	92	118°	120°	112°	
1FHGS13W	1HGS13W	1"	5.56	32	42	50	59	73	84	103	119	132	145	168	120°	125°	118°	
1 1/4FHGS19W		1 1/4"	6.6	47	61	72	87	106	122	150	173	194	212	245	122°	123°	120°	
1 1/2FHGS29W		1 1/2"	8.36	72	93	111	132	162	187	229	264	296	324	374	125°	125°	120°	
2FHGS56W		2"	11.1	140	180	214	255	313	361	442	510	571	625	722	125°	125°	118°	
2 1/2FHGS83W		2 1/2"	13.5	207	267	317	378	463	535	655	757	846	927	1070	122°	123°	120°	
3FHGS107W		3"	17.5	267	345	408	488	597	690	845	975	1090	1195	1379	125°	123°	123°	
4FHGS165W		4"	22.2	412	532	629	752	921	1064	1303	1504	1682	1842	2127	125°	125°	123°	